



The Community Foundation

BOULDER COUNTY

Non-profit e-News

June 2010

In this issue...

- :: Community Ventures
- :: Announcements & Events
- :: Thank You Community Partners
- :: COG Blog & TCF on Facebook

Community Ventures

The New Normal: Surviving & Thriving!

June 15th
Spice of Life Event Center
5706 Arapahoe Avenue, Boulder
7:30am - 3:30pm

[Click for full event agenda, pricing, and registration](#)

Featured Presenters and Resource Fair

Vendors:

Kim Klein
Maria Guajardo, Ph.D.
Ann Goldman & Leslie Allen
Kathy Policita
MobilzeUs
Colorado Generosity Project
Jared Polis Foundation
Brett Family Foundation
Volunteer Connection
Front Range Source
Colorado Health Foundation
Denver Foundation
Colorado Trust
Anschutz Family Foundation
Colorado Non-profit Association
MobilzeUs.com

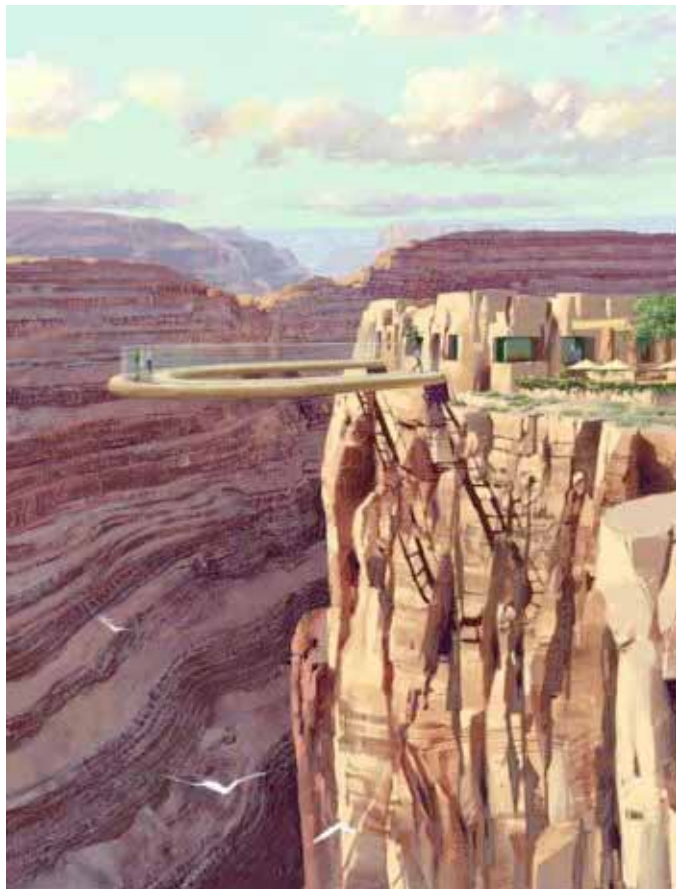

Presentation of the 2010 NOVA Award to one of three finalists:

Women's Health Technology Initiative
Providers Advancing School Outcomes (P.A.S.O.)
Boulder County Housing First

Thank you Sponsors:



NOVA Award Sponsors: Everest '96 Memorial Fund, CH2M Hill, Anchor Point Fund, and Anonymous Donor to The Community Foundation

Announcements & Events

Open Door Fund Proposals--Due July 14

[Check Here for details](#)

15 Forever Advisory Committee Member Applications--Due July 2

[Click Here for details](#)

Boulder County Leadership Fellows Program Applications --Due July 19

[Click Here for details](#)

Social Venture Partners Boulder County

Boulder County Board Match

This free event includes "How to be a How to Be a Non-profit Board Member" training and a "Non-profit Board Table Fair" and is open to anyone living or working in Boulder County. [See full invitation about the training or reserving a table for your non-profit at the Board Fair](#)

Tuesday, July 13, 2010

5:30 to 8:00pm, East Boulder Senior Center

Drinks will be provided. You are welcome to bring a brown bag dinner.

[RSVP Here](#)

Do you know it's now possible to register to vote online in CO?

GoVoteColorado.com

Anyone meeting voter requirements and who has a Colorado-issued driver's license or identification card can securely and easily: register to vote for the first time; confirm current voter information, and update address, party affiliation, or permanent mail-in ballot status.

Thank you Community Partners!

Join The Community Foundation's

Roche Colorado Corporation
Bolderwomen
Daily Camera
RegOnline
Vermilion
tuggl
Ehrhardt Keefe Steiner & Hottman PC
First Western Trust Bank
Wells Fargo Bank
Sterling-Rice Group
Western Disposal
Contrino Direct Marketing
Jared Polis Foundation
Ball Corporation
Elevations Credit Union
Kaiser Permanente Foundation

Facebook group and follow our COG Blog!

The Community Foundation is on Facebook. Get plugged in to Boulder County news and events you care about by searching for "Community Foundation of Boulder County" from your Facebook page. You can also stay informed by reading or subscribing to our [COG Blog](#). And if you're not yet signed up and using the COG Blog and Community Calendar for your own organization's news, email us at COG@commfound.org to get started.

The Community Foundation | 1123 Spruce Street | Boulder | CO | 80302